

Sierra School Equipment Company
 1911 Mineral Court
 Bakersfield, CA 93308
 Phone: (661)399-2993 Fax: (661)399-0218
 Space Planning Department

Project:

Mt. Diablo USD
 Loma Vista Adult Education
 Front Office
 1266 San Carlos Avenue
 Concord, CA 94518

Proprietary to Sierra School Equipment Company (SSEC).
 The ideas and drawings contained here are the exclusive
 property of SSEC and may not be used, duplicated or
 communicated to third parties, without the written permission
 of SSEC copyright 2020 SSEC

DATE: 09/13/2021
 DRAWN BY: Daisy Soto
 REVISION: 3
 SCALE: N/A

Approval: _____
 Date: _____

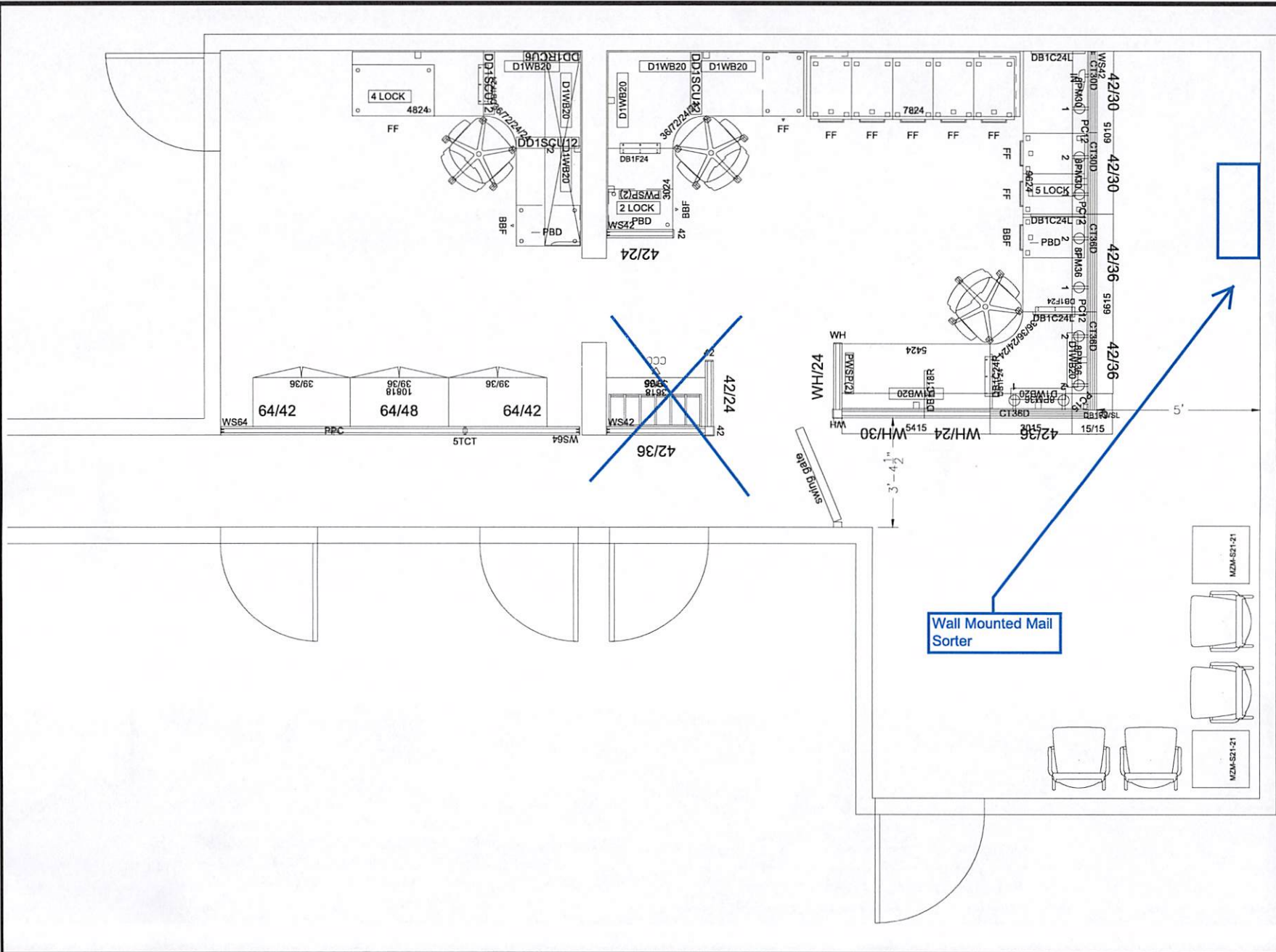

Wall Mounted Mail Sorter

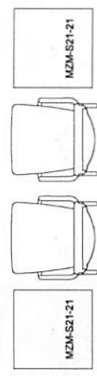

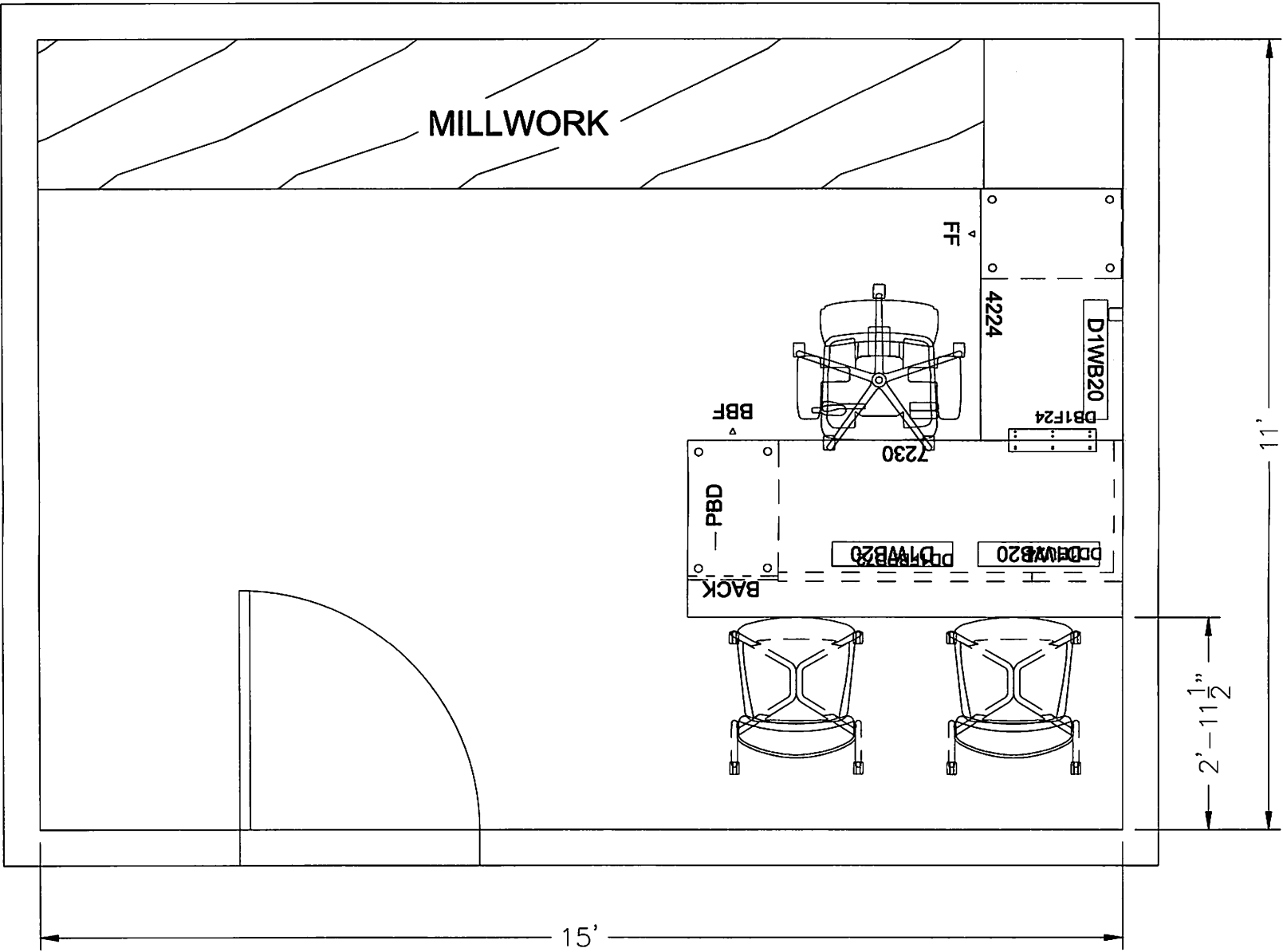

Sierra School Equipment Company
 1911 Mineral Court
 Bakersfield, CA 93308
 Phone:(661)399-2893 Fax:(661)399-0218
 Space Planning Department

Project:
 Mt. Diablo USD
 Loma Vista Adult Center
 Andrea Murphy's Office
 1266 San Carlos Avenue
 Concord, CA 94518

Proprietary to Sierra School Equipment Company (SSEC)
 The ideas and drawings contained here are the exclusive
 property of SSEC and may not be used, duplicated or
 communicated to third parties, without the written permission
 of SSEC copyright 2020 SSEC

DATE: 08/11/2021
 DRAWN BY: Daisy Solo
 REVISION:
 SCALE: N/A

Approval: _____
 Date: _____