

Quotation

25-Apr-2022

Quote No.: Q106967-2-TP



Attn: .
Customer: Mount Diablo Unified School
Address: 1936 Carlotta Dr.
City/State: Concord, CA 94519
Project: Mount Diablo USD - Pleasant Hill Elementary School
Phone: 925-682-8000
Fax: .
E-mail: .

Project Contact:
Phone / Fax:

Contact SSI:
 800.263.2363 / Fax 519.882.2697

Area No. 1 of 1 - Mount Diablo USD - Pleasant Hill Elementary School

Installation Site: Mount Diablo USD - Pleasant Hill Address: 2097 Oak Park Blvd. City / State: Pleasant Hill, CA 94523	Ship To: Mount Diablo USD - Pleasant Hill Address: 2097 Oak Park Blvd. City / State: Pleasant Hill, CA 94523	Quote Type: DuraSAFE Installed, Surface Mount Sub Base Type: Concrete (cured 10 days) Area (Sq. Ft.): 4394
---	---	---

Unit	Qty.	Color	Description	Thickness	Drop Ht.	Weight	List Price	Total Weight	Total List	Unit Cost
Each	608	Ocean Blue	DuraSAFE "Plus"	3.00"	6' 0"	29.66	\$48.00	18033.28	\$29,184.00	\$33.60
Each	557	Turf Green	DuraSAFE "Plus"	3.00"	6' 0"	29.66	\$48.00	16520.62	\$26,736.00	\$33.60
Each	259		Adhesive - Tile to Tile (tube)			1.65	\$9.25	427.35	\$2,395.75	\$9.25
Each	5		Bostik Greenfusion Adhesive - Tile to Base			56.80	\$241.00	284.00	\$1,205.00	\$241.00
Each	29		Polyurethane Foam Sealant			1.17	\$9.25	33.93	\$268.25	\$9.25
Each	1		Sourcewell Contract No. 010521-SFS			0.00	\$0.00	0.00	\$0.00	\$0.00

Installation

Prevailing Wage / Fair Wage - \$82.32

• Tearout

- Labour
- Miscellaneous - Included

Tear out and disposal of existing rubber surfacing.

• Installation

- Labour
- Surface Mount - Included
- Equipment Rental - Bobcat - Included
- Waste Bucket - Included
- Travel - Mobilization - Included
- Security - Not Included - To be supplied by others if required
- Miscellaneous - Included

Concrete pocket depth - 2.5"

Installation to be completed by non-union subcontractor of SURFACES USA.

IMPORTANT

This quotation has been priced based on the following realities:

1. At any point during the installation process, sofSURFACES Installation crews, or certified installation crews acting on behalf of sofSURFACES will have complete and uninterrupted access to the site until the construction phase of the project has been completed.

2. sofSURFACES will not be responsible for damages incurred to grounds throughout the installation process (this includes: concrete, grading, grass, gardens and/or plants, flowers etc.). It is understood by both parties that heavy equipment may be required in order to efficiently complete the project or gain access to the site.

3. sofSURFACES will not be held responsible for any ground repair needed and will make every effort to ensure that any property damage to the grounds is kept to a minimum throughout the duration of the project.

(Quoted value is subject to change upon notice of any ancillary costs. Additional costs may include [but are not limited to] required entry fees, special training, certifications, background checks and security clearances not previously identified as required or if the installation needs to be completed during weekend hours, within a very narrow window of time or under restricted special circumstances). A \$1,200/day fee will be charged for each day that our installers are on site after the agreed upon start date if the site is not ready for the installation to begin. A site features form, required photos request, completed dimensions verification form and elevation form request will be sent out for completion after the order is placed. These forms must be completed in full and returned no later than 4 business days prior to the scheduled installation start date otherwise the installation may be rescheduled to a later date at the discretion of the Installation Project Manager until said forms have been completed.

*****PLEASE NOTE: Should the sub base for your project be Compacted Granular, it MUST meet the following specification: (Type 1) 3/4 minus) compacted to 95% S.P.D. Not "clear" gravel.*****

Undersigned for Mount Diablo Unified School District accepts the terms and conditions which apply to this quotation.

X

SIGNED

DATE

Tile Layout - Area N° 1 - Mount Diablo USD - Pleasant Hill Elementary School

Area (Sq. Ft.): 4394

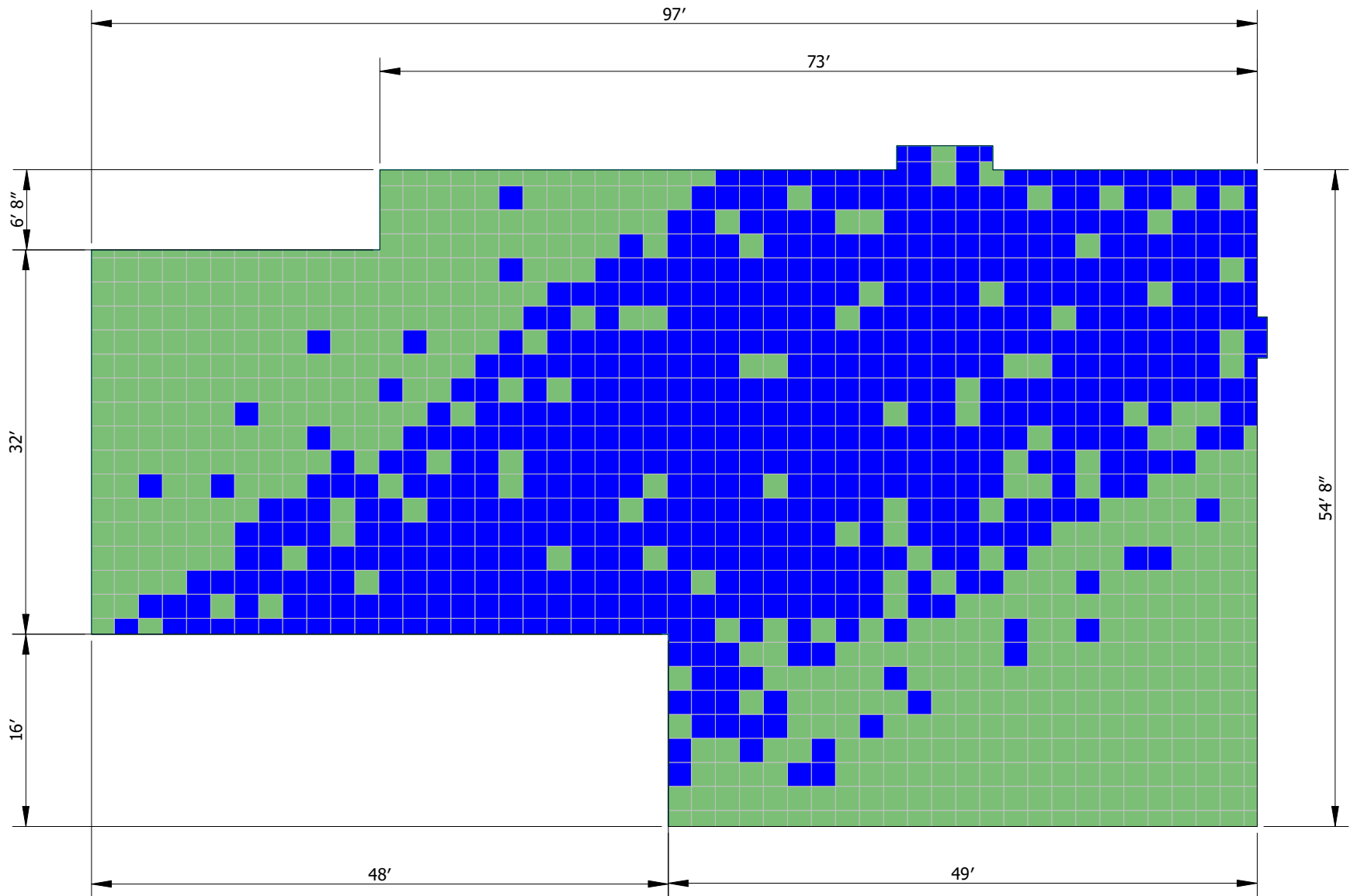

X _____ The material quantities proposed are based on this layout. If the layout is altered, this may influence the quantities needed for a successful installation. Please initial that you understand and agree.

Pallets: 15 Weight: 36575
 Dealer: Peter Druck - Denver, CO
 Shipping Options: Need Van, Residential Delivery

This proposal reflects a prevailing wage / fair wage rate of \$82.32 (including fringe). Should the prevailing wage / fair wage requirement be determined to be higher or lower, a revised proposal will be required.

Upon timely completion of the project, sofsURFACES Inc. shall be entitled to, and shall submit a payment request for, the amount indicated herein. In the event that only substantial completion is accomplished (i.e., the site is usable but not completely finished), sofsURFACES Inc. shall be entitled to, and shall submit a payment request for, up to 95% of the amount indicated herein, allowing for the customer to reserve 5% until completion of the project, upon which time sofsURFACES Inc. shall be entitled to, and shall submit a payment request for, the remaining balance owed. Quoted value is subject to change upon notice of additional associated costs. Additional costs may include (but are not limited to) required entry fees, special training, certifications, background checks and security clearances.

15% Restock fee and shipping for plus tiles. No returns on premium tiles.

The drawings within this quote are based on measurements supplied to sofsURFACES and are not professional engineered drawings. It is the project manager's responsibility (not sofsURFACES or its dealer) to provide sofsURFACES with correct measurements and to ensure that all site specifications and site preparations (including without limitation slopes, ramps, and transition components) are compliant with local building codes, and prepared to sofsURFACES' requirements.

duraSAFE Plus Series tiles are manufactured utilizing recycled rubber. With aging and exposure to UV there is potential for carbon black-rub off. Please contact sofsURFACES for assistance.

FOR MAILED US PAYMENTS:
 Sof Surfaces Inc.
 Dept CH 19173
 Palatine, IL 60055-9173

FOR COURIERED US PAYMENTS:
 Sof Surfaces Inc. - Lockbox 19173
 5505 N Cumberland Avenue, STE 307
 Chicago, IL 60656-1471

FOR CANADIAN PAYMENTS:
 Sof Surfaces Inc.
 4393 Discovery Line
 Petrolia, ON, N0N 1R0

Total List Price:		\$59,789.00
Discount	30.00%	(\$16,776.00)
Total (After Third Party Discount):		\$43,013.00
Installation:		\$59,725.23
Shipping and Handling Charge:		\$6,740.04
Sub Total:		\$109,478.27
CA:	6.00%	\$2,580.79
CCONTRACOSTA:	0.25%	\$107.53
DPLEASANTHIL:	3.00%	\$1,290.39
Total in USD Funds:		\$113,456.98
Cost per sq.ft.:		\$25.82

Finance Options Available

*Estimated Monthly Payment, 1 Year Term: Min. Order = \$10,000.00 \$8,406.43 USD
 2 Year Term: Min. Order = \$25,000.00 \$4,392.77 USD
 3 Year Term: Min. Order = \$35,000.00 \$3,073.08 USD

*Monthly payment based on minimum 15% down deposit. Final Rate subject to OAC. For more information please contact our Finance Controller at 1-800-263-2363 or m.patterson@sofsurfaces.com.

Undersigned for Mount Diablo Unified School District accepts the terms and conditions which apply to this quotation.



X

SIGNED

Quote valid for 60 days.

DATE

