



Mobile Modular Management Corporation
 5700 Las Positas Road
 Livermore, CA 94551
 Phone: (925) 606-9000
 Fax: (925) 453-3201
 www.mobilemodular.com

Sale Quotation and Agreement

Quotation Number: 194794
 Customer PO/Ref:
 Date of Quote: 04/27/2018

Sign up for the Easy Sale Option (see end of document for details)

Customer Information	Site Information	Mobile Modular Contact
Mt Diablo USD 1936 Carlotta Drive Concord, CA 94519 hullb@mdusd.org	Mt Diablo USD 1490 Gasoline Alley Concord, CA 94520	Questions? Contact: Matt Benas Matt.Benas@mobilemodular.com Direct Phone: (925) 453-3122 Fax: (925) 453-3201

Product Information	Qty	Purchase Price	Extended Purchase Price	Taxable
Office, 12x60 HCD (Item1613) <i>2 Offices. Smaller Front Office. Size excludes 3' towbar. bldg. id 35708, sn 02011263S013703</i>	1	\$25,670.00	\$25,670.00	Y
Charges Upon Delivery	Qty	Charge Each	Total One Time	Taxable
Office, 12x60 HCD (Item1613)				
Block and Level Building (A3) (PW) <i>Prevailing WageCert. Payroll</i>	1	\$266.00	\$266.00	N
Delivery Haulage 12 wide	1	\$410.00	\$410.00	N
Delivery Haulage Permit 12 wide	1	\$81.00	\$81.00	N
Delivery Haulage Pilot 12 wide	1	\$237.00	\$237.00	N
Drawings, Wet Stamped, Foundation, Standard <i>Wet Stamped Engineered</i>	1	\$404.00	\$404.00	N
Install Foundation, Tiedown (Blvl) (PW) <i>Prevailing WageCert. Payroll</i>	14	\$131.00	\$1,834.00	Y
Installation, Skirting, Wood (PW) <i>Prevailing WageCert. Payroll</i>	144	\$17.75	\$2,556.00	Y
Metal steps (new)	2	\$1,012.00	\$2,024.00	Y
Mini Blinds	4	\$48.00	\$192.00	Y
Piers and Pads	1	\$368.00	\$368.00	Y
Title transfer fee	1	\$45.00	\$45.00	N
			<u>\$8,417.00</u>	
Total Estimated Charges				
		Subtotal	\$34,087.00	
		Taxes	\$2,856.35	
		Total Charges (including tax)	\$36,943.35	

Special Notes

Used/pre-prepped 12' x 60' modular building with vinyl tile flooring. Pricing is for a specific building in our fleet (bldg. id 35708, sn 02011263S013703) and is subject to availability. ^ Used building sale: Quotation is for a used modular building sold in "as is" condition. Unless stated otherwise, MMMC will only perform a general cleaning & repair, reseal the roof, doors & windows, and test the electrical, mechanical & plumbing systems to ensure working condition at the time of delivery.

Stairs: Mobile Modular standard adjustable height (30"-36"), one-piece metal stairs have been included. Securing stairs to the modular, adjusting stairs to the threshold of the doorway, adjusting the treads, landing or handrails to meet local, state or federal requirements are the sole responsibility of the Customer.

Site Installation Requirements: Prior to delivery, Customer shall mark the four corners where the building is to be placed on the site/pad location, and shall also mark the locations of door(s) and ramp(s). Should special handling be required to position, install, or remove the building on Customer's site due to site conditions/constraints and/or obstructions, Customer will be responsible for additional charges. Additional rolling charges may be applicable as site conditions necessitate.

Yes - Prevailing Wage: Pricing includes prevailing wage and certified payroll for installation work performed on site.

Thank you for contacting Mobile Modular.

Mobile Modular is a division of McGrath RentCorp.
 194794, 04-27-2018 12:41 PM prod

Sale Quotation and Agreement

Quotation Number: 194794

Customer PO/Ref:

Date of Quote: 04/27/2018



Fire Related Items: Unless noted, fire related items (alarms, sprinklers, smoke & heat detectors, and fire-rated walls, etc.) are not included.

General: Customer's site must be dry, compacted, level and accessible by normal truck delivery. Pricing does not include any clearing or grading of sites, obstruction removal, site or final building clean up, any asphalt transitions, dolly, crane, forklift, electrical or plumbing connections, window coverings, furniture, casework, appliances, doorstops, phone or data lines, gutters, downspouts or tie-in, temporary power, temporary fencing, traffic control, flagmen, soil and/or pull test, custom engineering, fees associated with inspections, city or county submittals and/or use permits, security screens, door bars and any item not specifically listed as being included.

Floor Plans

Office, 12x60 HCD (Item1613)

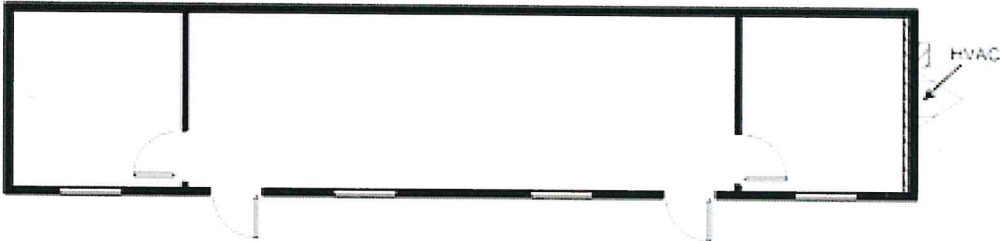

All drawings and specifications are nominal.

Additional Information

- Quote is valid for 30 days.
- Customer's site must be dry, compacted, level and accessible by normal truck delivery. Costs to dolly, crane, forklift, etc. will be paid by customer. Unless noted, prices do not include permits, stairs, foundation systems, temporary power, skirting, engineering, taxes or utility hookups.
- Subject to equipment availability. Unless noted, equipment and related furnishings, finishes, accessories and appliances provided are previously leased and materials, dimensions, and specifications vary. Detailed specifications may be available upon request.
- This transaction is subject to prior credit approval and all terms, conditions, and attachments of MMMC's standard contract.
- Down Payment required on execution.
- **Sales Tax will be calculated based on the tax rate at the time of invoicing.**
- **Unless otherwise noted, prices do not include prevailing wages, Davis-Bacon wages, or other special or certified wages.**

Thank you for contacting Mobile Modular.

Mobile Modular is a division of McGrath RentCorp.
194794, 04-27-2018 12:41 PM prod

Sale Quotation and Agreement

Quotation Number: 194794
Customer PO/Ref:
Date of Quote: 04/27/2018



Mobile Modular Easy Sale. Sign Me Up!

Getting your modular building on its way has never been easier... and faster. With Mobile Modular Easy Sale you can convert your Sale Quotation directly into a Sale Agreement by signing below. Once we receive your signed Easy Sale option, we'll finalize your building details and get your project on its way.

Review and acknowledge agreement.

This Quotation is subject to Mobile Modular Management Corporation, a California corporation, herein known as seller (the "Seller"), credit approval of Customer, herein known as buyer (the "Buyer"). Seller does not warrant that the equipment meets any local or state code not specifically listed herein. Equipment is subject to availability. By signing below, customer accepts the terms of this quotation including prices and specifications, and instructs Seller to make appropriate arrangements for the preparation and delivery of the Equipment identified herein, and agrees that such signature constitutes customer's acceptance of and agreement to the Seller's Sale Agreement. Such sale, and customer's agreement thereto, is subject to Seller's standard terms and conditions located on the Seller's web site at (www.mobilemodular.com/contractterms) which are incorporated by reference herein. Customer may request a copy of the terms and conditions from Seller. No alterations, additions, exceptions, or changes to any Quotation or Agreement made by Buyer shall be effective against Seller, whether made hereon, contained in any printed form of Sale or elsewhere, unless accepted in writing by Seller. Any customer purchase order or other customer-provided document purporting to replace, supersede or supplement the terms and conditions of the Seller's Sale Agreement shall carry no force or effect except as an instrument of billing.

Seller:

Mobile Modular Management Corporation

By: _____

Name: _____

Title: _____

Date: _____

Buyer:

Mt Diablo USD

Signature: _____

Print Name: _____

Title: _____

Date: _____

Thank you for contacting Mobile Modular.

Mobile Modular is a division of McGrath RentCorp.
194794, 04-27-2018 12:41 PM prod