



# MT. DIABLO

## UNIFIED SCHOOL DISTRICT

### **Sequoia Elementary Playground Improvements**

January 22, 2025 Board Meeting

*Melanie Koslow, Executive Director of Maintenance, Operations & Facilities*

*Elyse Galetto, President, Sequoia Elementary Parent Association*

*Aaron Edell, Past President, Sequoia Elementary Parent Association*

*Becky Vichiquis, Sequoia Elementary Principal*

*Ms. Ricard, Sequoia Elementary Third Grade Teacher & Students*

# Sequoia Elementary School

Project Overview: Steps taken to enhance and elementary school facilities through collaborative efforts

This project represents a partnership between the Sequoia Parent Group (SPA), Sequoia Elementary School & the Maintenance, Operations & Facilities Department. The collaboration aims to improve the school's facilities to create a safer, more engaging, and student-friendly learning environment. By leveraging the skills and resources of the maintenance team alongside the fundraising and organizational efforts of parents, the Staff & Students of Sequoia Elementary will receive a wonderfully restored outside play & learning environment.

o



# Project Goals Sequoia Elementary School

Shaded Seating Area

Track Replacement

Play Structure Modernization

Soft Surface Replacement

Playground Improvements

Basketball Backstops

Teacher Ball

Asphalt Patching

US Map (New Location)





# SPA

## Sequoia Parent Association

- ★ Who is SPA
- ★ History
- ★ Goals
- ★ Process Followed
- ★ Future Plans

<https://sequoiaparentsassociation.com>

# Shade Location for Students & Outside Learning

## Project Goal:

To Provide Outdoor Shaded Location for Students & Learning



1. Asphalt Paving under solar array
2. Picnic Table Installation

# Sequoia Elementary School Third Grade Project

## Presented by Ms. Ricard & 3rd Grade Students Nora and Mosawr

Third grade was selected for this project due to “Area” and “Reason with Shapes and their attributes” being areas of relative weakness on last year’s CAASPP Math test.

Spring 2024 CAASPP Math: Grade 3		
Target A Represent and solve problems involving multiplication and division.	Similar	Above
Target B Understand properties of multiplication and the relationship between multiplication and division.	Similar	Above
Target C Multiply and divide within 100.	Similar	Above
Target D Solve problems involving the four operations, and identify and explain patterns in arithmetic.	Worse	Above
Target E Use place value understanding and properties of operations to perform multi-digit arithmetic.	Worse	Near
Target F Develop understanding of fractions as numbers.	Worse	Above
Target G Solve problems involving measurement and estimation of intervals of time, liquid volumes, and masses of objects.	Similar	Above
Target H Represent and interpret data.	Better	Above
Target I Geometric measurement: Area.	Worse	Below
Target J Geometric measurement: Perimeter.	Similar	Above
Target K Reason with shapes and their attributes.	Similar	Near

Measuring the space for the paving of the outdoor eating area.







Modelling the picnic tables in the space.



## Existing Primary Play Structure



Site Visit between SPA, Principal & MOF Staff  
Site Visit with Play Structure Manufacture to Review Options  
Reviewed full replacement versus a combination Maintenance  
Repair & Play Structure Modification Option

**General Notes:**

Age Group  
 2-5 yrs  5-12 yrs  12-17 yrs  18+ yrs

1. The Americans with Disabilities Act (ADA) may require that you make your park and/or playground accessible when viewed in its entirety. Please consult your local authority for information on the ADA website: [www.ada.gov](http://www.ada.gov)

2. Approved surfacing must be utilized in appropriate areas.

3. All playground equipment must be installed in accordance with the proposed frame board dimensions in regards to the appropriate number of ground level events. The actual dimensions may be in compliance when considering the following:

4. All dimensions are measured from top of ground cover.

5. Round all pipe components.

6. The maximum height of the fall zone around the entire structure is 9'6".

7. All pipe heights are identified by the drawing the post heights. A "6" represents a 66 inch post.

8. Not all equipment may be appropriate for all children. Supervision is required.

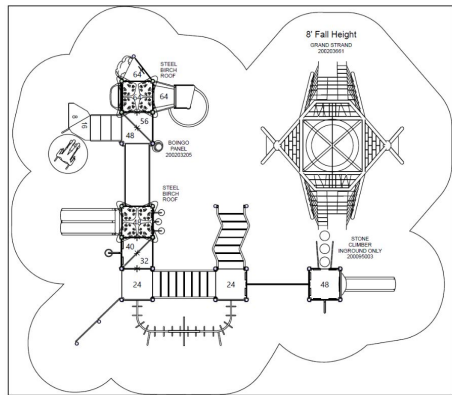

**Refresh Existing Equipment**

- \* Remove Plastic Roofs and Replace with Steel Birch Roofs
- \* Remove Circle Overhead
- \* Remove 24" Square Deck
- \* Remove Back Transfer Station
- \* Replace All Plastic Slides
- \* Replace 8' Side Step Climber
- \* Replace Transfer Station Pie Decks and Steps
- \* Install New 48" Stone Climber
- \* Install New Grand Strand Net Climber 8' Fall Height



**Playground Layout Compliance:**

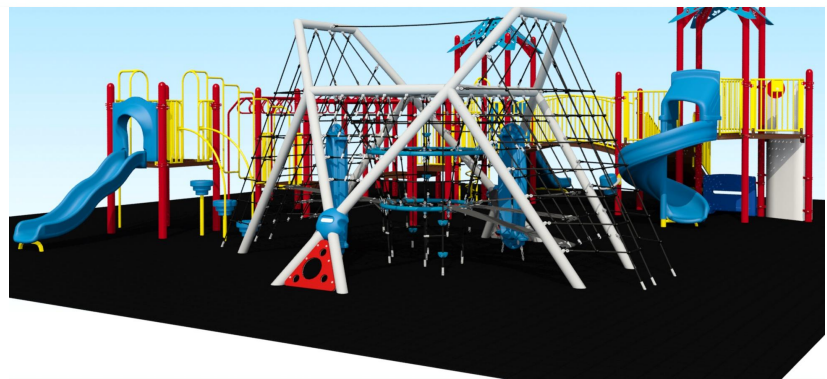

# Sequoia Elementary School

## Maintenance Projects

1. Track Replacement
2. Added Teether Ball Court
3. Basketball Backstop Replacement (x5)
4. US Map Relocation

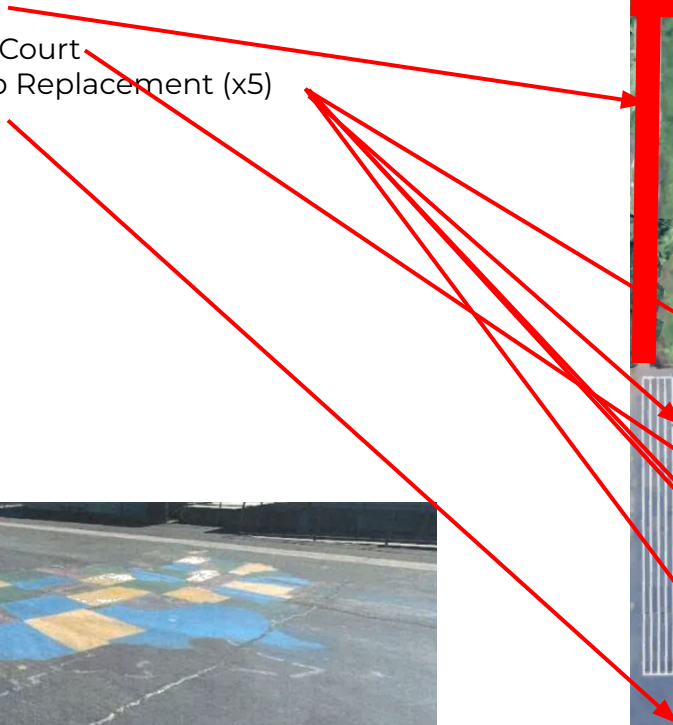
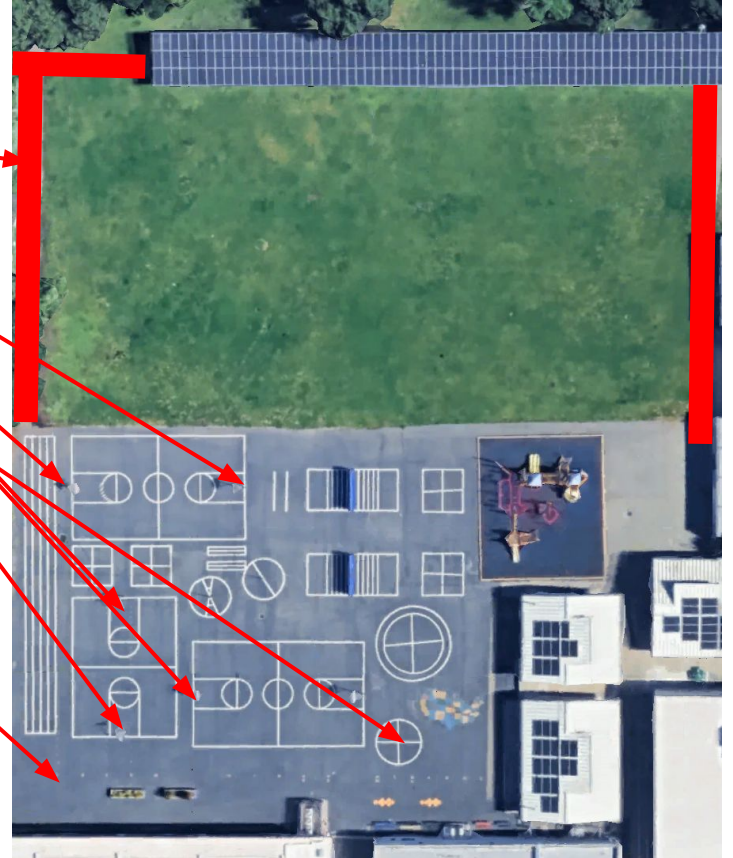

# Sequoia Elementary School

## Playground Improvements

Estimated costs will be covered through a mix of fundraising efforts and school district allocations.

This collaboration serves as a model for community-driven improvements that support education and well-being in schools.

# SPA

QUOTATION

PlayPower LT Farmington C/O

All About Play Inc

3844 Presidio Street, Sacramento, CA 95838

Phone: 916-923-2180 Fax: 916-646-6383

www.playgroundpros.com



**TO:** Sequoia Elementary  
Primary Playground Replacement  
Refresh Existing Playground  
Elyse Gallette  
Elyse Gallette  
egallett@sequoia.k12.ca.us  
glen@playgroundpros.com

**DATE:** September 4, 2024  
**BY:** Glen Wurster  
916.923.2180 PH

**REFERENCE:** Kid Builder - Add-On Parts

Little Tikes Commercial Equipment - Sourcewell/NJPA Contract #010521-LTS				
Qty	Description	Each	Total	
1	Grand Strand 8' Fall Height 200203661	\$ 44,951.00	\$ 44,951.00	
1	Stone Climber 2000095003	\$ 2,459.00	\$ 2,459.00	
1	Bounce Panel 200003005	\$ 415.00	\$ 415.00	
8	NuEdge Birch Top Roof Section 200203766	\$ 682.00	\$ 5,456.00	
	<b>Sourcewell/NJPA Discount</b>	17.00%	\$ (9,057.77)	
	<b>SUB TOTAL:</b>		\$ 44,223.23	
<b>TAX:</b>	Sales tax is an estimate final tax will be charged based on final shipping address	9.125%	\$ 4,035.37	
<b>FREIGHT:</b>	Shipping cost of \$4,800.00 cover by Sourcewell		No Charge	
<b>INSTALLATION:</b>	Remove & reinstall existing playground tiles as needed Remove & dispose of circle overhead, square deck, & transfer station Remove and replace existing slides, roofs, side step, transfer station parts Install new playground items Receive, offload, and store playground delivery		\$ 49,646.00	
<b>TOTAL:</b>			\$ 97,904.60	

Quote Good for 60 Days

Current lead time is 6 plus weeks for delivery.

Installer will receive and offload equipment upon delivery.

Not Responsible for Underground Utilities, Obstructions or Permits of Any Kind.

If not quoted above, Customer is responsible for construction fencing, site preparation and irrigation re-routing.

To process non-municipal orders, a completed Credit Application is required and a deposit may be required.

Please make purchase orders out to:

PlayPower LT Farmington C/O All About Play, 3844 Presidio St., Sacramento, CA 95838

Remit All Payments To:

PlayPower LT Farmington PO Box 734155 Dallas, TX 75373-4155

I accept the terms and pricing listed on the above quotation:

Signature: \_\_\_\_\_ Date: \_\_\_\_\_

# MDUSD

QUOTATION

PlayPower LT Farmington C/O

All About Play Inc

3844 Presidio Street, Sacramento, CA 95838

Phone: 916-923-2180 Fax: 916-646-6383

www.playgroundpros.com



**TO:** Mr Diablo USD  
FG Posts-Red Accents Yellow Vinyl KB Slides Cyan

**DATE:** September 4, 2024  
**BY:** Robin Tassas  
916.923.2180 PH

**CONTACT:** Melanie Kostlov  
925.596.0446  
melaniek@mdusd.org

**EMAIL:** kostlov@mdu.edu

**REFERENCE:** Sequoia ES Playground Replacement Parts

Little Tikes Commercial Equipment				
MATERIALS:	Qty	Description	Each	Total
909532CV	1	Spiral Slide Bedway	\$ 1,674.00	\$ 1,674.00
923497CV	1	Spiral Slide Hood pre 2017	674.00	674.00
HW14734-1	1	HRDW PKG Spiral Slide	73.00	73.00
20000980	1	48" Wave Slide	1,488.00	1,488.00
200006976	1	48" Double Wide Slide	1,724.00	1,724.00
910530BR	1	3 steps DK/DK	1,071.00	1,071.00
HW16250-1	1	HRDW PKG	17.66	17.66
HW16252-2	1	HRDW PKG	28.00	28.00
HW16252-3	1	HRDW PKG	9.27	9.27
HW16252-4	1	HRDW PKG	39.00	39.00
902717BR	2	Sno cone Decks	522.00	1,044.00
910194YLW	1	96" side step climber only	851.00	851.00
HW115732-1	1	HRDW PKG	48.00	48.00
	<b>SUB TOTAL:</b>		\$ 8,740.93	
<b>TAX:</b>	Sales tax is an estimate final tax will be charged based on final shipping address	9.750%	\$ 852.24	
<b>FREIGHT:</b>	Free Shipping with Sourcewell Equipment Order		No Charge	
<b>TOTAL:</b>			\$ 9,593.17	

Quote Good for 30 Days

Current lead time is 6 plus weeks for delivery.

Price increases or surcharges may be applied due to the volatility of steel and raw material cost.

This quote is for product only delivered and does not include installation of any kind.

Freight cost is for shipping only it does not include receipt or offloading.

Customer is responsible to offload the truck when it arrives.

To process non-municipal orders, a completed Credit Application is required and a deposit may be required.

Please make purchase orders out to:

PlayPower LT Farmington C/O All About Play, 3844 Presidio St., Sacramento, CA 95838

Remit All Payments To:

PlayPower LT Farmington PO Box 734155 Dallas, TX 75373-4155

I accept the terms and pricing listed on the above quotation:

Signature: \_\_\_\_\_ Date: \_\_\_\_\_

# Other Costs

Play Structure Soft Surface - \$90,122.30 (MDUSD)  
Picnic Tables - Approx \$25K (SPA & MDUSD)  
Asphalt Paving - Approx 35K-60K  
Maintenance Repairs (MDUSD)

# Thank You



**MT. DIABLO**  
UNIFIED SCHOOL DISTRICT